

LMVZ7550A-1R

3Mega Pixel



Type	AI VARI		Mount	CS	
Focal Length	7.5~50.0mm		Back Focus	9.269~10.693mm	
Fno.	F1.5		Mechanical Bf	8.2mm	
Designed Image Format	1/2.7" (φ 6.6mm)		Exit Pupil	-79.473 ~ -57.764mm	
Operation Range	Iris	F1.5-F360	Filter Size	-	
	Focus	0.5m~∞	Aperture	Front	
	Zoom	7.5~50.0mm		Rear	φ 30.3mm φ 9.2mm
Control	Iris	DC Galvanometer	Dimension	φ 46.3 x 68.4mm	
	Focus	Manual Control			
	Zoom	Manual Control	Weight	162g	
	ICR	-			
Object Size at MOD	Wide	4:3 268.0x363.4mm	16:9	220.2x460.6mm	
	Tele	47.1x62.8mm			39.0x69.6mm
Field of View	D	47.4° ~ 7.8°	16:9	48.2° ~ 7.9°	
	H	4:3 38.0° ~ 6.2°			42.2° ~ 6.8°
	V	28.6° ~ 4.6°			23.6° ~ 3.8°
Control	Iris	Focus	Zoom	-	
Driving Coil/Supply Volt	190Ω	-	-	-	
Damping Coil/Current	1310Ω	-	-	-	
Response Time	-	-	-	-	
Potentiometer	-	-	-	-	
Light Measuring Method	-				
Input Signal	-				
Iris Accuracy	-				
Sensitivity Adjustment	-				
Operating Temperature	-10 ~ +50 °C				

DIMENSIONS

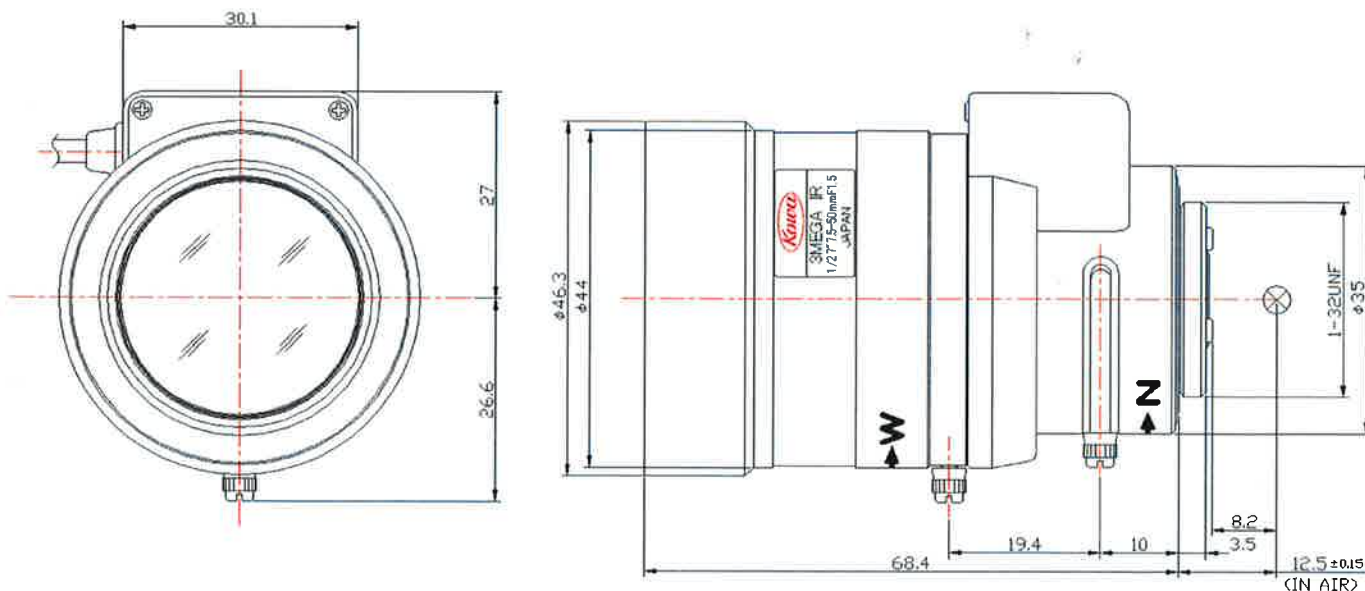

Wiring Diagram

4 Pin Standard Connector for Auto Iris

Pin No. 1	Damping (-)
Pin No. 2	Damping (+)
Pin No. 3	Driving (+)
Pin No. 4	Driving (-)

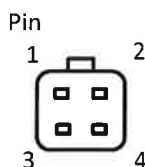

Subject to change without notice